

OMNI LOUISVILLE HOTEL MEETING SPACE

LEVEL TWO

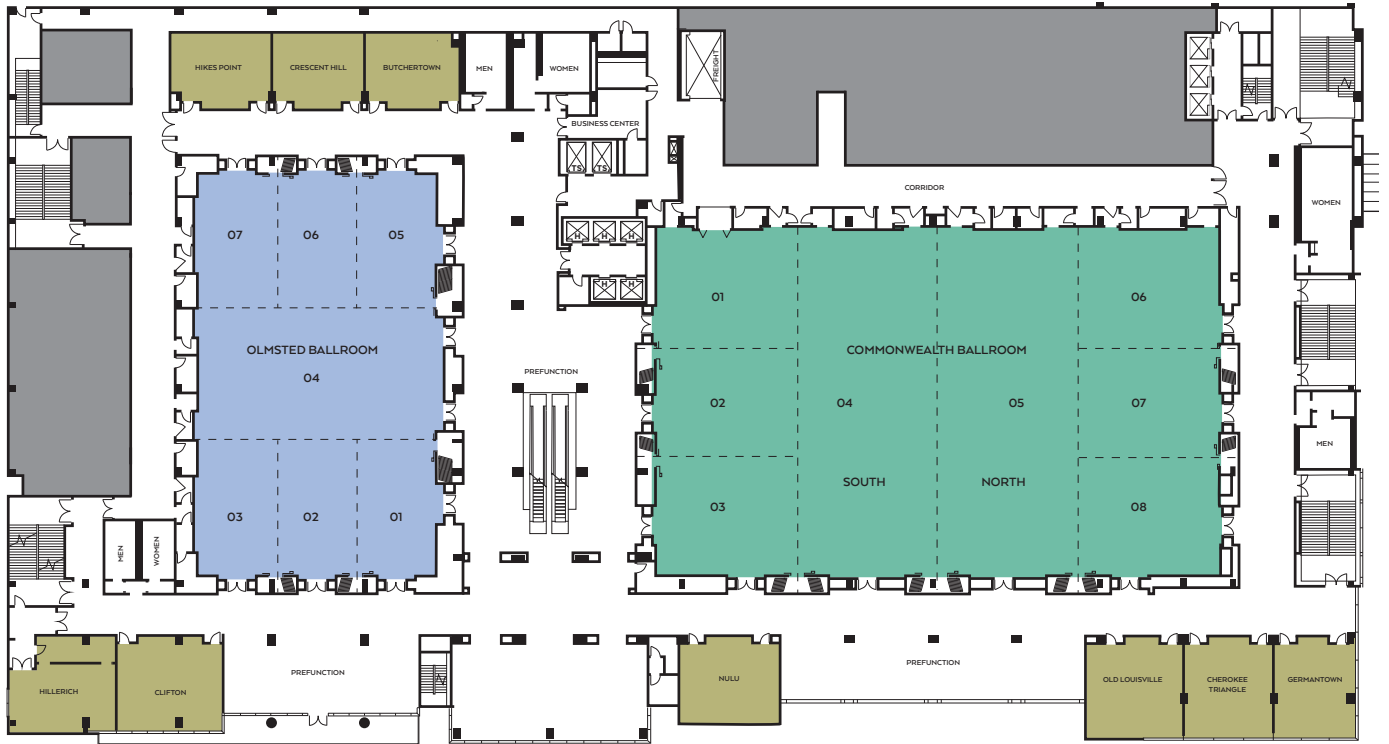

LEVEL THREE



OMNI LOUISVILLE HOTEL MEETING ROOM CAPACITY

	SQUARE FOOTAGE	HEIGHT	BANQUET 72"	CLASSROOM	U-SHAPE	THEATRE	RECEPTION	EXHIBIT 8 X 10	EXHIBIT 10 X 10	CONFERENCE
LEVEL 2 COMMONWEALTH BALLROOM	20,361	23'	1,440	1,227	186	2,250	2,036	127	102	156
COMMONWEALTH SOUTH										
COMMONWEALTH 1/2/3/4	10,189	23'	760	675	126	1,176	1,019	64	51	90
COMMONWEALTH 1/2/3	5,101	23'	350	342	105	594	501	31	25	96
COMMONWEALTH 1/2	3,355	23'	240	234	72	385	336	21	17	60
COMMONWEALTH 2/3	3,344	23'	240	234	72	385	334	21	17	60
COMMONWEALTH 1	1,757	23'	120	105	42	200	176	11	9	30
COMMONWEALTH 2	1,598	23'	120	105	42	198	160	10	8	30
COMMONWEALTH 3	1,746	23'	120	105	42	200	175	11	9	30
COMMONWEALTH 4	5,088	23'	370	360	105	616	509	32	25	96
COMMONWEALTH 4/5	10,176	23'	690	684	120	1,050	1,018	64	51	90
COMMONWEALTH NORTH										
COMMONWEALTH 5/6/7/8	10,172	23'	760	675	126	1,176	1,017	64	51	90
COMMONWEALTH 6/7/8	5,084	23'	350	342	105	594	501	31	25	96
COMMONWEALTH 6/7	3,344	23'	240	234	72	385	334	21	17	60
COMMONWEALTH 7/8	3,333	23'	240	234	72	385	333	21	17	60
COMMONWEALTH 5	5,008	23'	370	360	105	616	501	31	25	96
COMMONWEALTH 6	1,751	23'	120	105	42	200	175	11	9	30
COMMONWEALTH 7	1,593	23'	120	99	42	199	159	10	8	30
COMMONWEALTH 8	1,740	23'	120	105	42	200	174	11	9	30
PREFUNCTION	12,278									
LEVEL 2 OLMSTED BALLROOM	10,185	22.5'	740	576	129	1,008	1,019	64	51	108
OLMSTED 1/2/3/4	6,793	22.5'	490	405	99	720	679	42	34	72
OLMSTED 1/2/3	3,443	22.5'	240	234	72	396	344	22	17	60
OLMSTED 1/2	2,286	22.5'	160	144	48	288	229	14	11	36
OLMSTED 2/3	2,286	22.5'	160	144	48	288	229	14	11	36
OLMSTED 1	1,157	22.5'	80	63	36	131	116	7	6	30
OLMSTED 2	1,129	22.5'	80	63	36	143	113	7	6	30
OLMSTED 3	1,157	22.5'	80	63	36	131	116	7	6	30
OLMSTED 4	3,350	22.5'	240	252	72	456	335	21	17	60
OLMSTED 4/5/6/7	6,742	22.5'	490	405	99	720	674	42	34	72
OLMSTED 5/6/7	3,392	22.5'	240	234	72	396	339	21	17	60
OLMSTED 5/6	2,252	22.5'	160	144	48	288	225	14	11	36
OLMSTED 6/7	2,252	22.5'	160	144	48	288	225	14	11	36
OLMSTED 5	1,140	22.5'	80	63	36	131	114	7	6	30
OLMSTED 6	1,112	22.5'	80	63	36	143	111	7	6	30
OLMSTED 7	1,140	22.5'	80	63	36	131	114	7	6	30
PREFUNCTION	9,836									
LEVEL 2 MEETING ROOMS	7,386									
GERMANTOWN	803	15'	50	48	24	76	80	—	—	18
CHEROKEE TRIANGLE	850	15'	50	54	24	88	85	—	—	18
OLD LOUISVILLE	917	15'	60	60	27	100	92	—	—	18
NULU	812	15'	50	48	24	85	81	—	—	18
CLIFTON	972	15'	60	60	30	110	97	—	—	24
BUTCHERTOWN	695	15'	50	36	24	72	70	—	—	18
CRESCENT HILL	676	15'	40	36	24	71	68	—	—	18
HIKES POINT	729	15'	50	45	27	78	73	—	—	18
HILLERICH	932	—	—	—	—	—	—	—	—	22
LEVEL 3 MEETING ROOMS	4,413									
RYE	517	12'	30	24	21	54	52	—	—	18
BARLEY	541	12'	30	27	21	52	54	—	—	18
WHEAT	1,056	12'	80	57	36	112	106	—	—	42
OAK	518	12'	30	27	21	54	52	—	—	18
CHARRED	681	12'	40	36	24	68	68	—	—	18
BARREL	748	12'	40	42	21	76	75	—	—	18
MALT	677	12'	40	36	21	69	68	—	—	18
COPPER	687	12'	40	33	24	68	68	—	—	18
FINISHING	352	—	—	—	—	—	—	—	—	8

Meeting room capacities were determined using 72" rounds of 10 (rounds capacity), 3 chairs per 6x30" table (U-shape and conference capacity), 3 chairs per 6x18" table (conference capacity) allowing for minimal audiovisual equipment.