

# Meetings & Event Guide.

OMNI BARTON CREEK RESORT & SPA



EXPERIENCES MATTER HERE



OMNI  
BARTON CREEK



# Inspired spaces for INSPIRING EVENTS.

Discover the true essence of Texas at Omni Barton Creek Resort & Spa, nestled among the rolling hills of Texas Hill Country. Immerse yourself in the breathtaking panoramic views surrounding this serene property, from the welcoming guest rooms to the pool decks and event spaces.

With over 76,000 square feet of flexible meeting and event space, Omni Barton Creek offers a range of options to accommodate any gathering. Whether you prefer the elegance of our ballrooms or the open-air ambiance of our expansive lawns, you can create a memorable event that seamlessly blends with the natural beauty of the landscape. The Hill Country Pavilion seamlessly blends indoor and outdoor spaces, allowing you to bask in the splendor of the rolling terrain.



*about*  
Omni Barton Creek  
Resort & Spa.

**GATEWAY TO THE TEXAS HILL COUNTRY**

The Omni Barton Creek Resort & Spa offers a tranquil retreat among the gentle slopes and ancient trees of Central Texas. With premium golf courses, a serene spa, pools for adults and families and so much more, this engaging resort is a welcome getaway for business travelers and families. Enjoy a slower pace of life amid the abundant sunshine of this urban retreat.



- 493 inviting guest rooms and suites take their design inspiration from the surrounding Texas landscape
- Over 76,000 square feet of flexible meeting, event and pre-function space, including the 14,532 square foot Brazos Ballroom, 15,000 square feet of event lawns and the indoor/outdoor Hill Country Pavilion
- On-site audiovisual equipment services offering the latest technology and Wi-Fi internet access
- Four distinct 18-hole golf courses, each with stunning Hill Country scenery; courses include Palmer Lakeside designed by golf great Arnold Palmer and top-rated Fazio Canyons designed by legendary architect Tom Fazio
- An adults-only infinity pool and hot tub overlook the hills, and two family-friendly pools plus splash pad
- Eight unique dining experiences, including healthy, seasonal dishes at Blind Salamander; nationally renowned steakhouse Bob's Steak & Chop House; golf clubhouse 19th hole Crenshaw's Bar & Eatery; sleek lobby bar Jim Bob's Lobby Lounge; Latin-inspired restaurant Nopales; poolside dining with fruity and frozen drinks from Travis Pool Bar & Grill.
- Mokara Spa, a 13,000 square foot oasis inspired by nearby creeks and springs with private rooftop pool, sauna, steam room, hot tub and a comprehensive selection of body and facial treatments
- A 33,000 square foot fitness center offering group fitness classes or individual exercise with Peloton® bikes, free weights, indoor lap pool, running track and much more

# Flexible, Next Generation Event & Meeting Space.

## HILL COUNTRY PAVILION

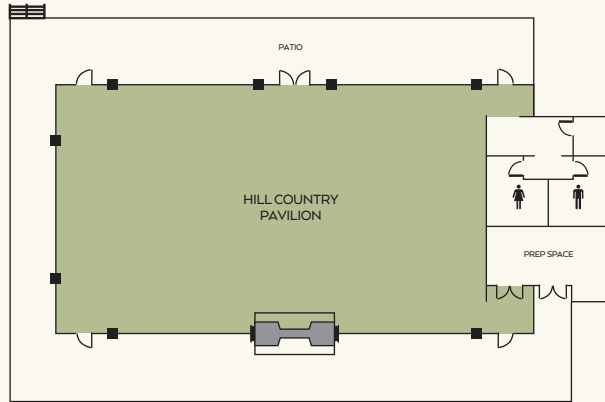

## LOBBY LEVEL (BLUEBONNET)

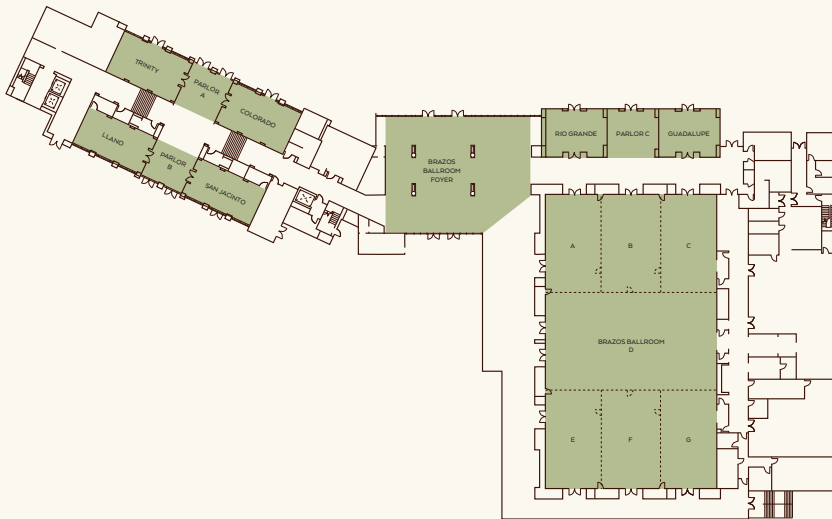

## CONFERENCE LEVEL (CEDAR)

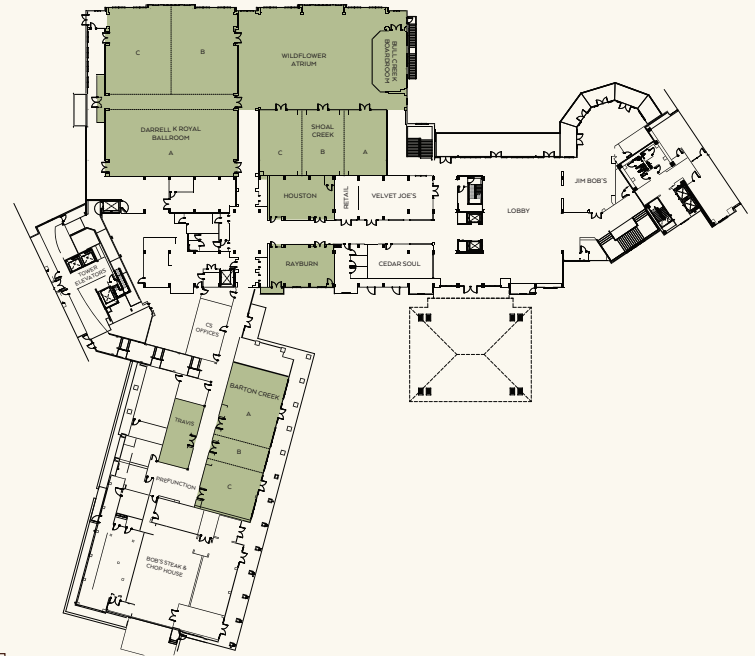

	SQUARE FOOTAGE	DIMENSIONS	WINDOWS	CEILING HEIGHT	BANQUET 72"	THEATER	CLASSROOM 18"	RECEPTION	CONFERENCE
<b>MAIN LEVEL</b>									
<b>BARTON CREEK</b>	2,850	89'X32'	YES	16'	140	345	120	220	—
A	1,440	46'X32'	YES	16'	80	160	56	110	28
B	450	14'X32'	YES	16'	20	54	—	30	16
C	960	30'X32'	YES	16'	50	128	30	70	16
A & B	1,890	59'X32'	YES	16'	100	240	76	145	32
B & C	1,410	44'X32'	YES	16'	80	192	64	110	28
<b>HOUSTON</b>	967	37.8'X25.6'	—	12'	50	96	30	70	20
<b>RAYBURN</b>	1,015	39.5'X25.7'	YES	12'	50	96	30	75	20
<b>TRAVIS</b>	701	17.83'X39'	—	16'	20	56	20	40	16
<b>DARRELL K ROYAL BALLROOM</b>	8,240	103'X80'	YES	12'	480	900	270	700	—
A	3,200/3,920	40'X80'	—	12'	180	400	108	250	—
B	2,160	54'X40'	YES	12'	120	180	60	210	28
C	2,160	54'X40'	YES	12'	120	200	60	210	28
B & C	4,320/5,040	54'X80'	—	12'	220	360	144	300	—
<b>SHOAL CREEK</b>	2,964	76'X39'	—	12'	180	360	120	225	—
A	988	25.3'X39'	—	12'	60	160	36	75	20
B	988	25.3'X39'	—	12'	60	160	36	75	20
C	988	25.3'X39'	—	12'	60	160	36	75	20
A & B OR B & C	1,976	50.5'X39'	—	12'	120	270	72	150	28
<b>BULL CREEK BOARDROOM</b>	740	20'X37'	YES	12'	—	—	—	—	22
<b>WILDFLOWER ATRIUM</b>	2,600	65'X40'	YES	12'	200	—	—	300	—
<b>LOWER LEVEL</b>									
<b>BRAZOS BALLROOM</b>	14,532	92'X158'	—	24'	1,000	2,070	630	1,250	—
A, B, C & D	9,686	92'X105.3'	—	24'	720	1,440	448	850	—
A, B & C	4,846	92'X52.8'	—	24'	280	810	216	450	—
A	1,632	31'X52.8'	—	24'	100	285	72	155	46
B	1,577	30'X52.8'	—	24'	100	300	72	150	46
C	1,637	31.1'X52.8'	—	24'	100	300	72	155	46
D	4,840	92'X52.7'	—	24'	320	810	238	450	86
E	1,632	31'X52.8'	—	24'	100	285	72	155	46
F	1,577	30'X52.8'	—	24'	100	300	72	150	46
G	1,637	31.1'X52.8'	—	24'	100	300	72	155	46
<b>BRAZOS BALLROOM FOYER</b>	5,414	83.6'X63.2'	YES	17'	—	—	—	541	—
<b>TRINITY</b>	950	40'X24.6'	YES	14'	50	135	30	80	32
<b>COLORADO</b>	950	40'X24.6'	YES	14'	50	135	30	80	32
<b>PARLOR A</b>	652	23.9'X25.1'	—	14'	—	—	—	65	—
<b>LLANO</b>	813	39.8'X21.8'	YES	14'	60	140	36	75	24
<b>SAN JACINTO</b>	813	39.8'X21.8'	YES	14'	60	140	36	75	24
<b>PARLOR B</b>	717	23.9'X29'	—	14'	—	—	—	72	—
<b>RIO GRANDE</b>	754	32.9'X25.4'	YES	14'	50	108	30	70	20
<b>GUADALUPE</b>	754	32.9'X25.4'	YES	14'	50	108	30	70	20
<b>PARLOR C</b>	706	29.3'X26'	—	14'	—	—	—	71	—
<b>OUTDOOR SPACE</b>									
<b>HILL COUNTRY PAVILION</b>	5,556	93.1'X59.3'	—	20'	360	720	—	500	—
<b>HILL COUNTRY COURTYARD</b>	2,892	—	—	—	—	—	—	—	—
<b>HILL COUNTRY LAWN</b>	10,400	—	—	—	500	—	—	—	—
<b>LADY BIRD LAWN</b>	4,593	—	—	—	—	—	—	150	—
<b>LONGHORN LAWN</b>	6,000	—	—	—	—	—	—	—	—
<b>ROCK HOUSE</b>	7,500	—	—	—	200	—	—	—	—

MEETING ROOM CAPACITIES WERE DETERMINED USING 72" ROUNDS OF 10 (ROUNDS CAPACITY), THREE CHAIRS PER 6'X30" TABLE (U-SHAPE CAPACITY) AND THREE CHAIRS PER 6'X18" TABLE (CLASSROOM CAPACITY) ALLOWING FOR MINIMAL AUDIOVISUAL EQUIPMENT.

# Austin

## highlights

At the entrance to the famous Texas Hill Country, Omni Barton Creek Resort & Spa encourages you to slow down and disconnect. Take in the area's natural beauty at expansive natural areas and approachable hiking trails. Head further into the hills to tour the wineries of the Texas Wine Trail. Just a short drive away, creative Austin will keep you busy with fantastic restaurants, eclectic shopping and that legendary live music scene.

### AIRPORTS

Austin-Bergstrom International Airport | 26 min

### ATTRACTIONS

Congress Avenue Bat Bridge | 21 min

Bob Bullock Texas State History Museum | 23 min

Texas State Capitol/Texas Capitol Visitors Center | 23 min

Lyndon B. Johnson Presidential Library and Museum | 29 min

### RECREATION

Wild Basin Wilderness Preserve | 8 min

Zilker Botanical Garden | 16 min

Barton Springs/Zilker Park | 18 min

Lady Bird Johnson Wildflower Center | 21 min

South Congress Avenue | 23 min

Hill Country Helicopter Tours | 34 min

### ENTERTAINMENT

ACL Live at the Moody Theater | 21 min

Moody Center | 25 min

Circuit of the Americas Racetrack | 38 min



**OMNI BARTON CREEK RESORT & SPA**  
**8212 BARTON CLUB DRIVE**  
**AUSTIN, TEXAS 78735**  
**OMNIHOTELS.COM/BARTONCREEK**

